

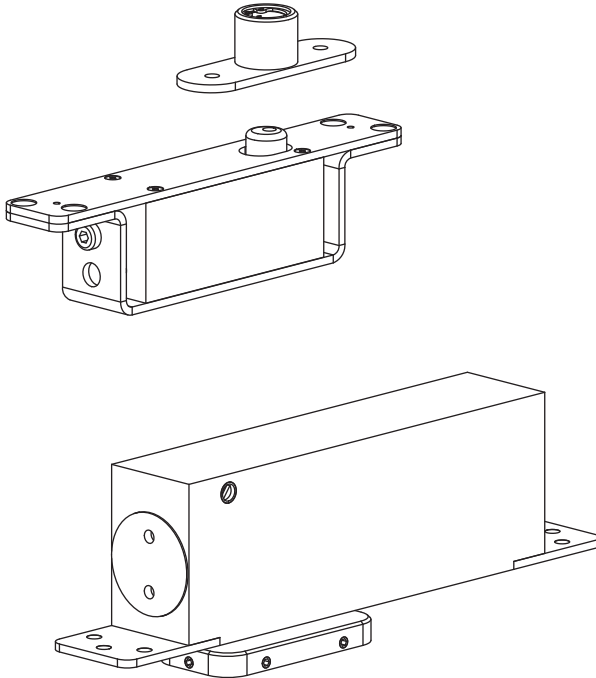

CLOSING SYSTEMS



IN.05.212.HO

SISTEMA PIVOTANTE HIDRÁULICO -200 SWIVEL
HYDRAULIC PIVOTING SYSTEM - 200 SWIVEL
SISTEMA HIDRÁULICO DE PIVOTE - 200 SWIVEL



INSTALLATION VIDEO



Conteúdo / Content / Contenido

Ferramenta necessária / Necessary tools / Herramienta necesaria	2
Dimensão da porta / Door dimension / Dimensión de la puerta	3
Desenho técnico / Technical drawing / Diseño técnico	4
Entalhe / Cutout / Taladro	6
Esquema de perfuração / Drilling scheme / Esquema de perforación	8
Instalação / Installation / Instalación	9
Ajustes de posição / Position adjustment / Ajuste de posición	17
Ajuste de velocidade / Speed adjustment / Ajuste de velocidad	19

Ferramentas necessárias (Não incluídas) /

Tools required (Not included) / Herramientas necesarias (No incluidas)



Berbequim /
Driller /
Taladrador



Nível laser /
Laser level/
Nivel láser

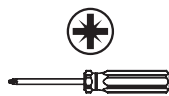

Chave Philips /
Philips Screwdriver /
Destornillador Philips

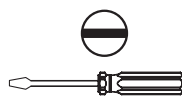

Chave de fenda /
Screwdriver /
Destornillador

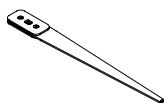

IN.05.ST
Chave especial/
Special key/
Llave especial

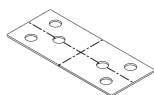

IN.05.215.50 (opcional)
Ferramenta Furação /
Drill tool /
Herramienta de perforación

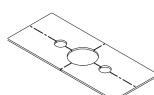

IN.05.215.51 (opcional)
Ferramenta Furação /
Drill tool /
Herramienta de perforación



Broca Ø12mm /
Drill bit Ø12mm /
Broca Ø12mm

Ferramentas incluídas / Tools included / Herramientas incluidas

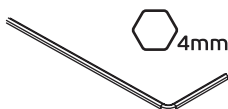

IN.05.214.16
Chave especial /
Special key/
Llave especial

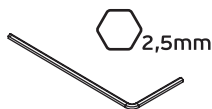

Chave Allen 2,5mm /
Allen key 2,5mm /
Llave Allen 2,5mm

Centrado/ Centered / Centrado

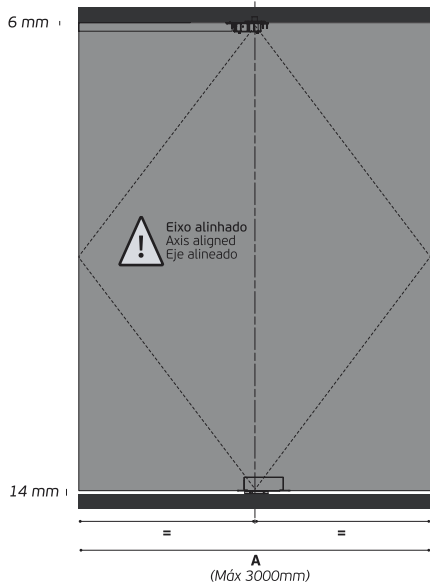

Y (Máx 4000mm)
X=Y-20

FOLGAS / CLEARANCE / HOLGURAS

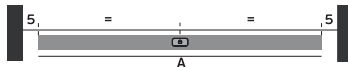

Max.
200kg



A < X
B < C

Descentrado/ Decentered / Descentrado

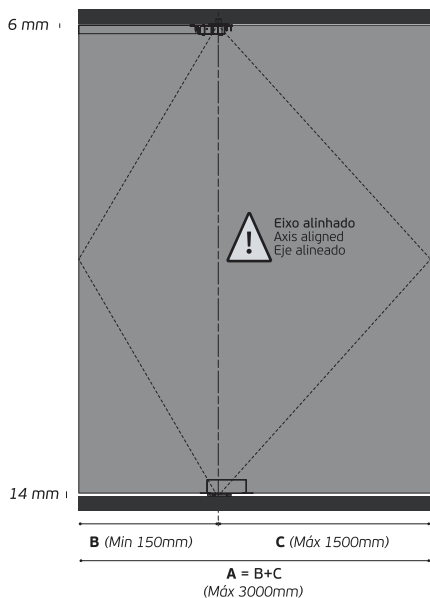

Y (Máx 4000mm)
X=Y-20

FOLGAS / CLEARANCE / HOLGURAS



		b'		
B	T (min)	50	60	70
	150 - 200	4	6	8
250 - 1500	3	4	4	

		c'		
B	T (min)	50	60	70
	150 - 200	4	6	8
250 - 1500	3	4	4	

Max. 150kg $B_{min.} = \frac{A}{5}$

Max. 100kg $B_{min.} = \frac{A}{7}$

Max. 60kg $B_{min.} = 150mm$

IN.05.UP1

Pivot superior standard/
Standard Upper pivot/
Pivote superior standard

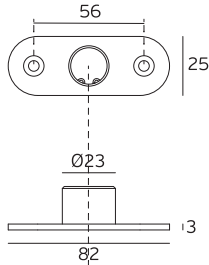

Superior (Aro) /
Top (Rim) /
Superior (Aro)

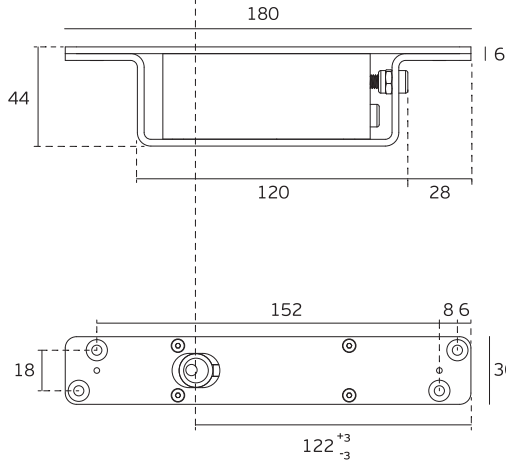
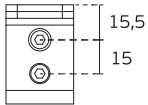

Superior (Porta) /
Top (Door) /
Superior (puerta)

*Pivots superiores opcionais/
Optional upper pivots/
Pivotes superiores opcionales*

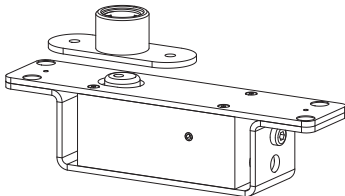

IN.05.UP2

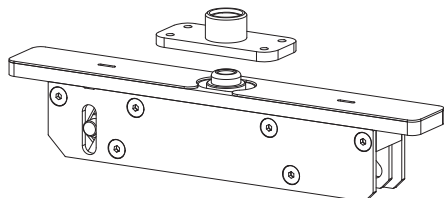

IN.05.UP3

Superior (Aro) /
Top (Rim) /
Superior (Aro)

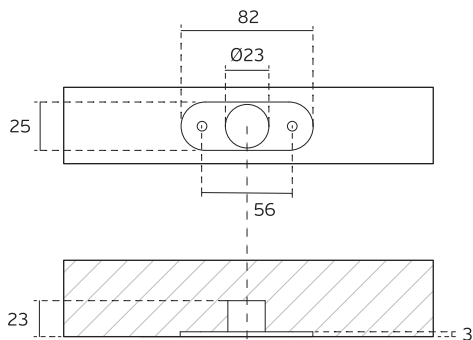

Superior (Porta) /
Top (Door) /
Superior (puerta)



Rasgo de 8mm até ao exterior da porta /
8mm slot to the exterior of the door /
Taladro de 8mm al exterior de la puerta

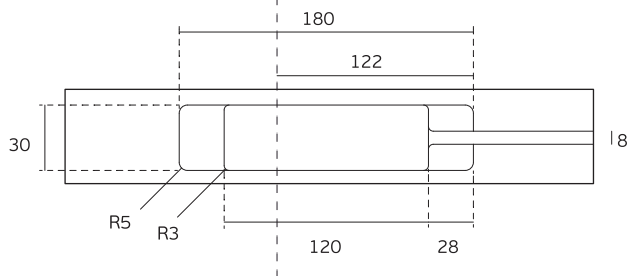
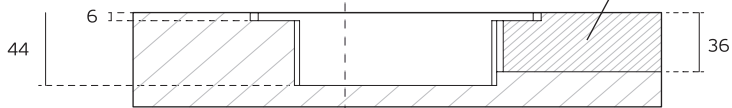

Eixo / Axis / Eje

Inferior (Porta)
Bottom (Door) /
Inferior (Puerta)

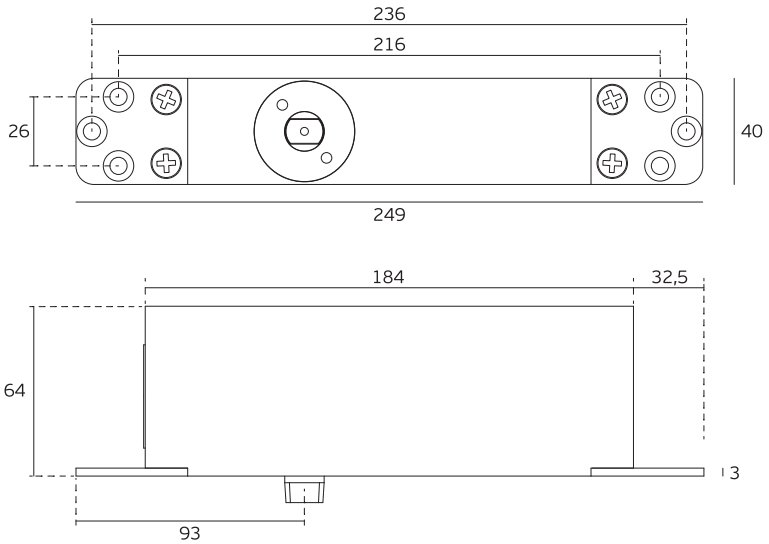

IN.05.BH1

Base de pavimento standard/
Standard floor base/
Base de suelo standard

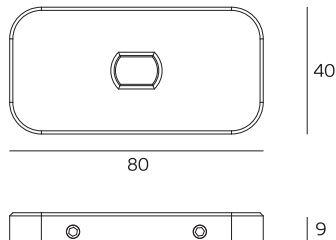

Bases opcionais/
Opcional bases/
Bases opcionales

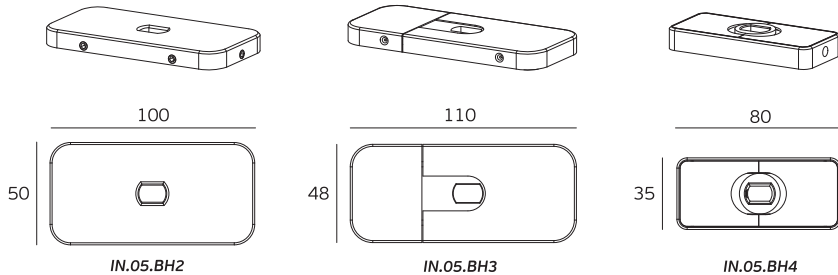

Inferior (Porta)
Bottom (Door) /
Inferior (Puerta)

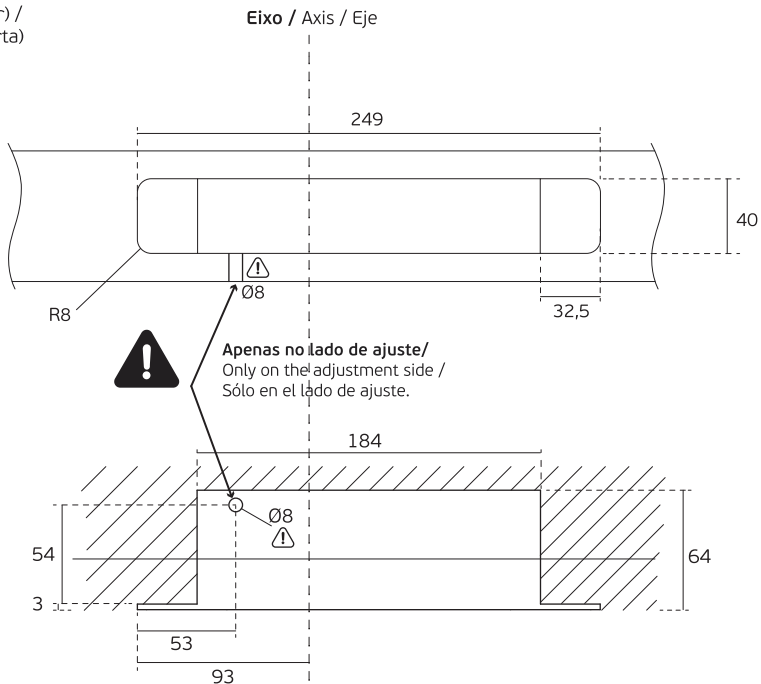

Inferior (Pavimento)
Bottom (Floor) /
Inferior (Suelo)

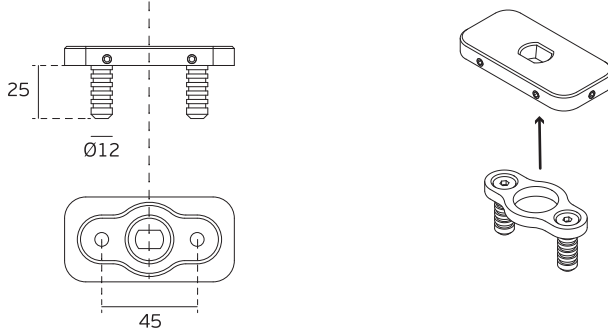

OBS:

Os acessórios de fixação e o sistema de ancoragem (mecânico ou químico) deverão ser escolhidos de acordo com a estrutura, onde irá ser aplicado o produto. Esta escolha, assim como a sua aplicação, deverá ser executada por um profissional./

Fixing accessories and anchoring system (mechanical or chemical) shall be chosen according to the structure, where the product will be applied. This choice, like its application, should be executed by a professional./

Los accesorios de fijación y el sistema de anclaje (mecánico o químico) deben elegirse según la estructura donde se aplicará el producto. Esta elección, así como su aplicación, debe ser realizada por un profesional.



Chão de cimento
Concrete floor
Piso de cemento

BH1
STANDARD

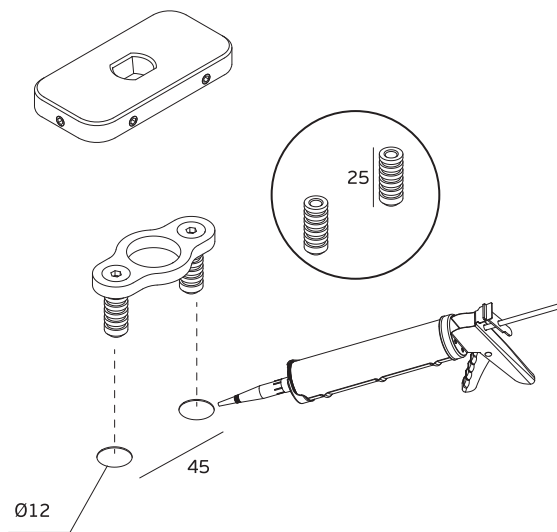

Seguir tempo de cura
definido pelo fabricante /
Follow curing time defined
by the manufacturer /
Siga el tiempo de curado
definido por el fabricante



OBS:
Os acessórios de fixação e o sistema de ancoragem (mecânico ou químico) deverão ser escolhidos de acordo com a estrutura, onde irá ser aplicado o produto. Esta escolha, assim como a sua aplicação, deverá ser executada por um profissional./

Fixing accessories and anchoring system (mechanical or chemical) shall be chosen according to the structure, where the product will be applied. This choice, like its application, should be executed by a professional./

Los accesorios de fijación y el sistema de anclaje (mecánico o químico) deben elegirse según la estructura donde se aplicará el producto. Esta elección, así como su aplicación, debe ser realizada por un profesional.

Instalação / Installation / Instalación



Piso radiante
Radian floor
Suelo radiante

BH1
STANDARD

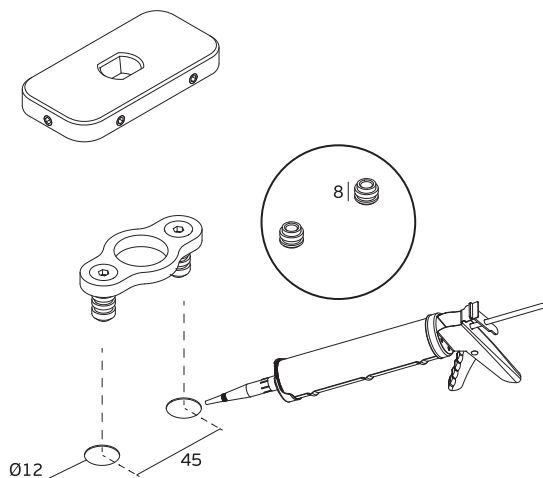

Seguir tempo de cura
definido pelo fabricante /
Follow curing time defined
by the manufacturer /
Siga el tiempo de curado
definido por el fabricante

Instalação / Installation / Instalación



Aço
Steel
Acero

BH1
STANDARD

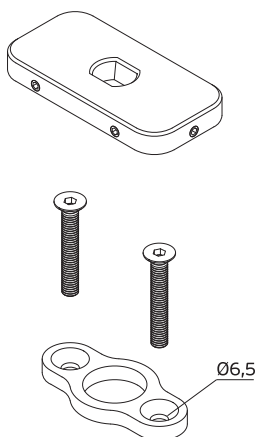

Instalação / Installation / Instalación



Junta
Joint
Junta

BH3
OPTIONAL

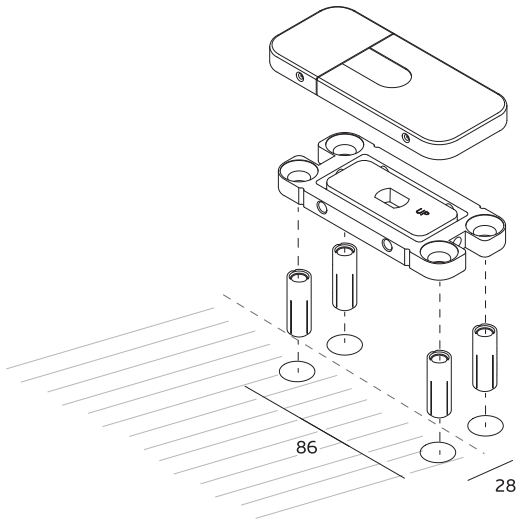

Instalação / Installation / Instalación



Perfil
Profile
Perfil

BH4
OPTIONAL

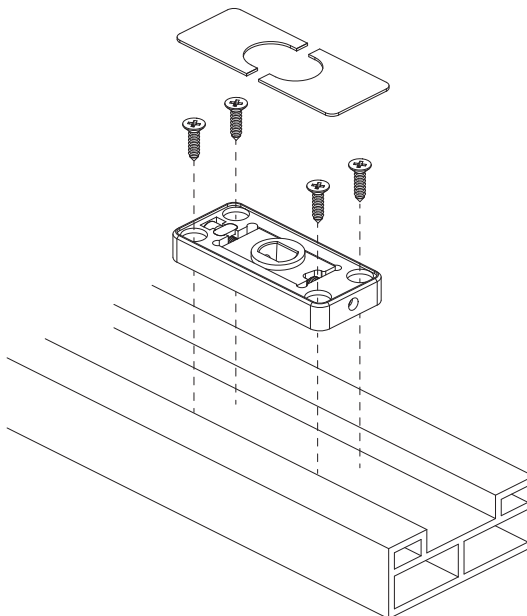

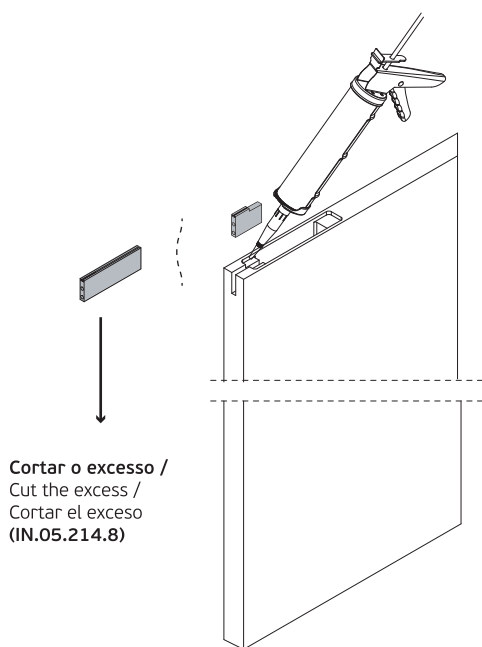
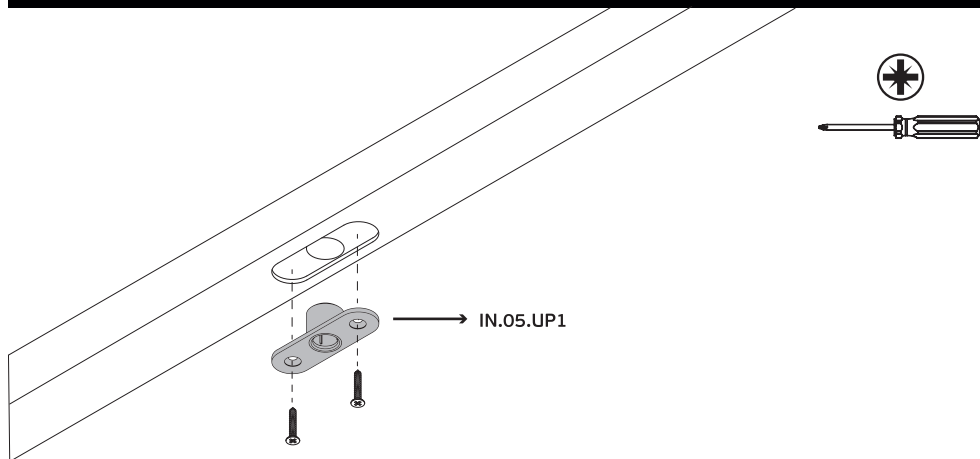

Seguir tempo de cura
definido pelo fabricante /
Follow curing time defined by
the manufacturer /
Siga el tiempo de curado
definido por el fabricante

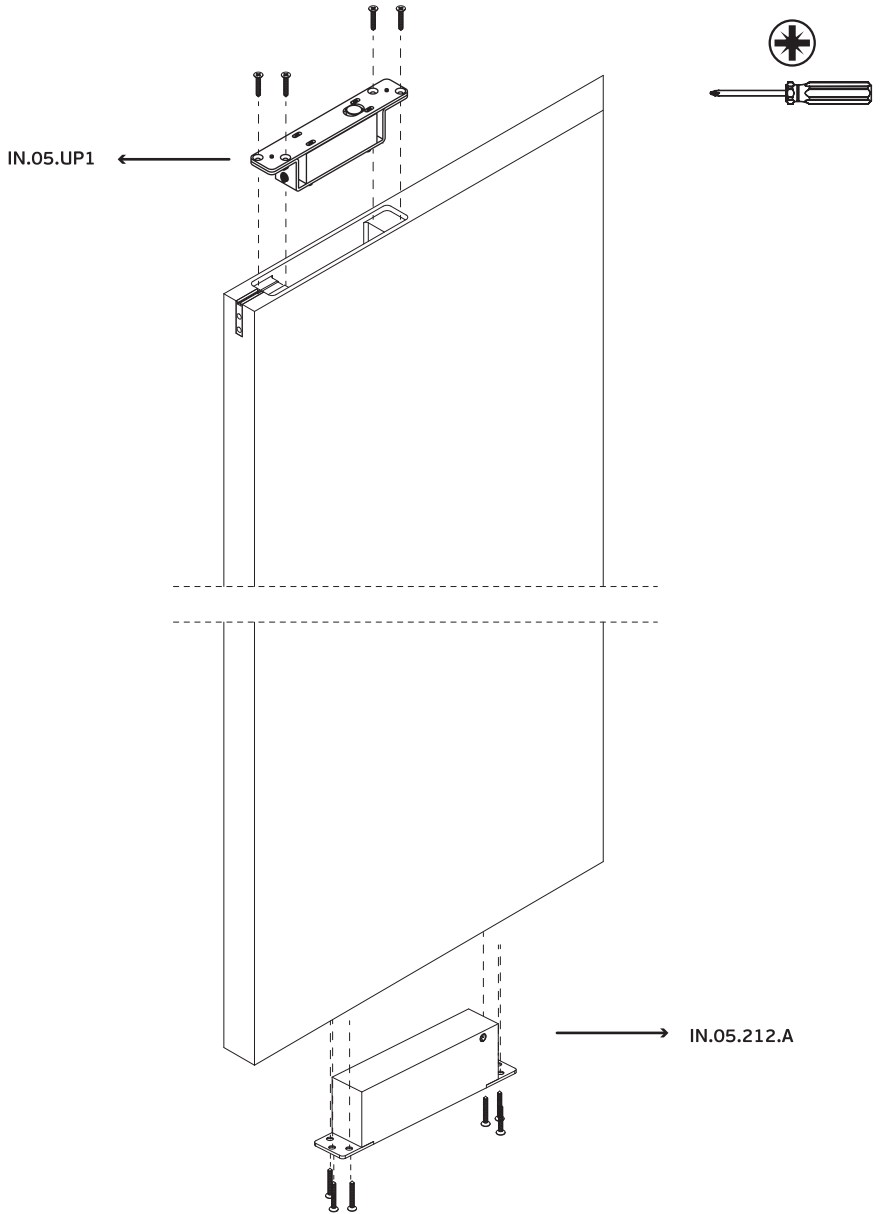

Rodar 90° de acordo com o lado da montagem

Rotate 90° according to the mounting side

Girar 90° según el lado de montaje.

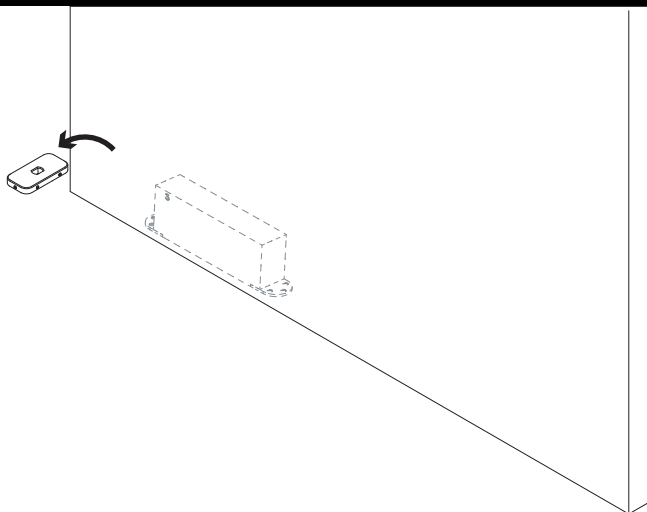
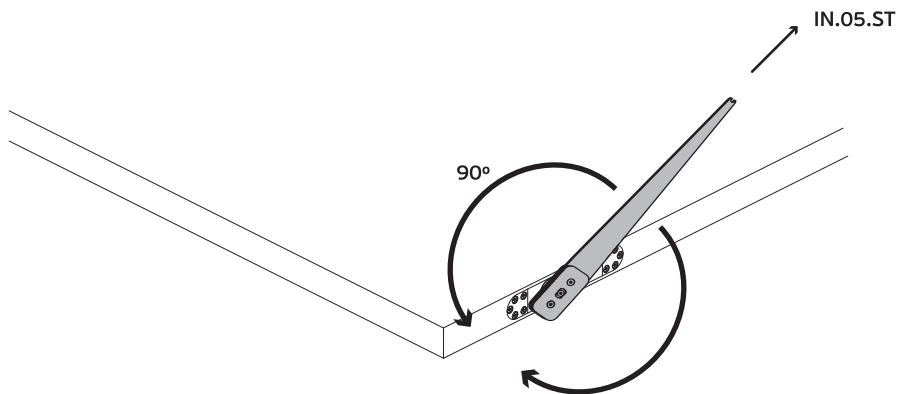



Em caso de passagem de cabo (opcional) /
In case of cable routing (optional) /
En caso de cableado (opcional) /

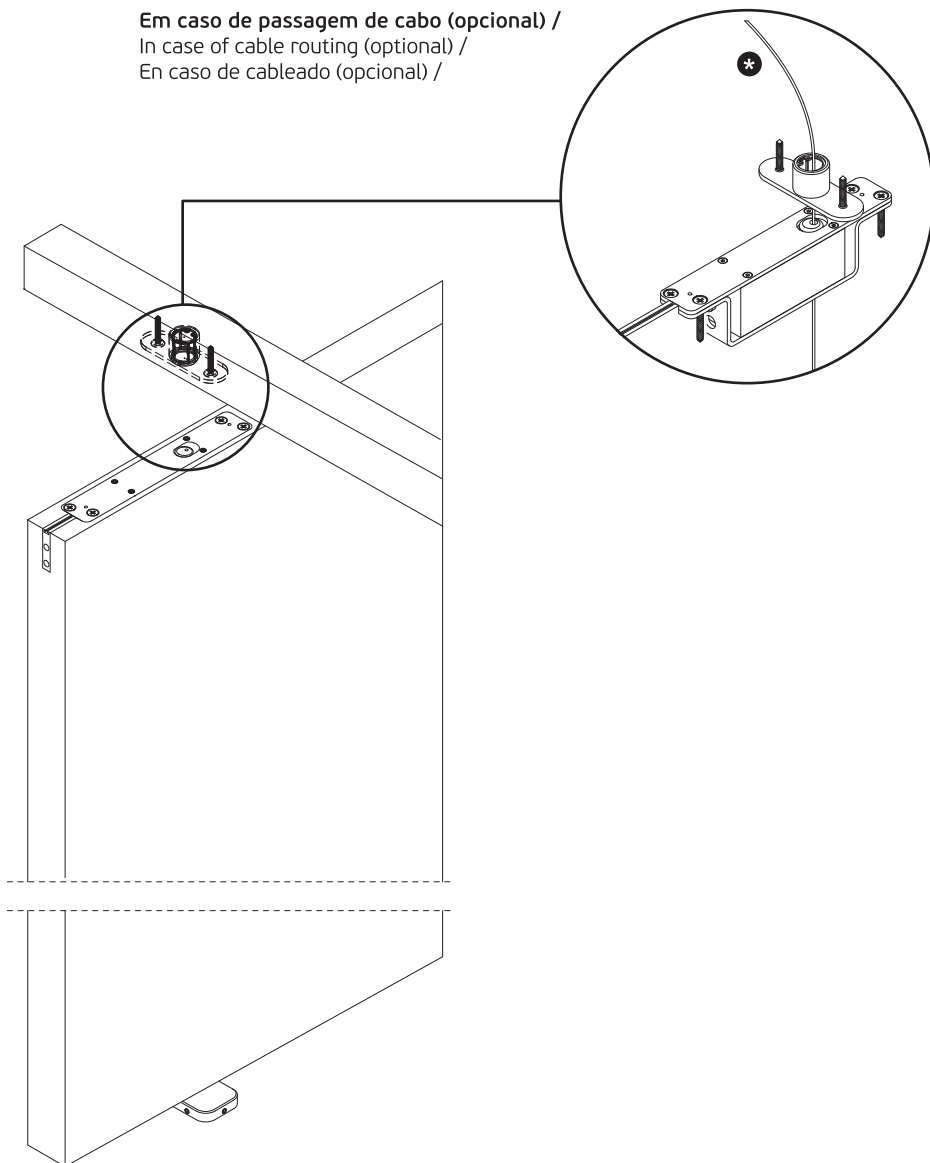

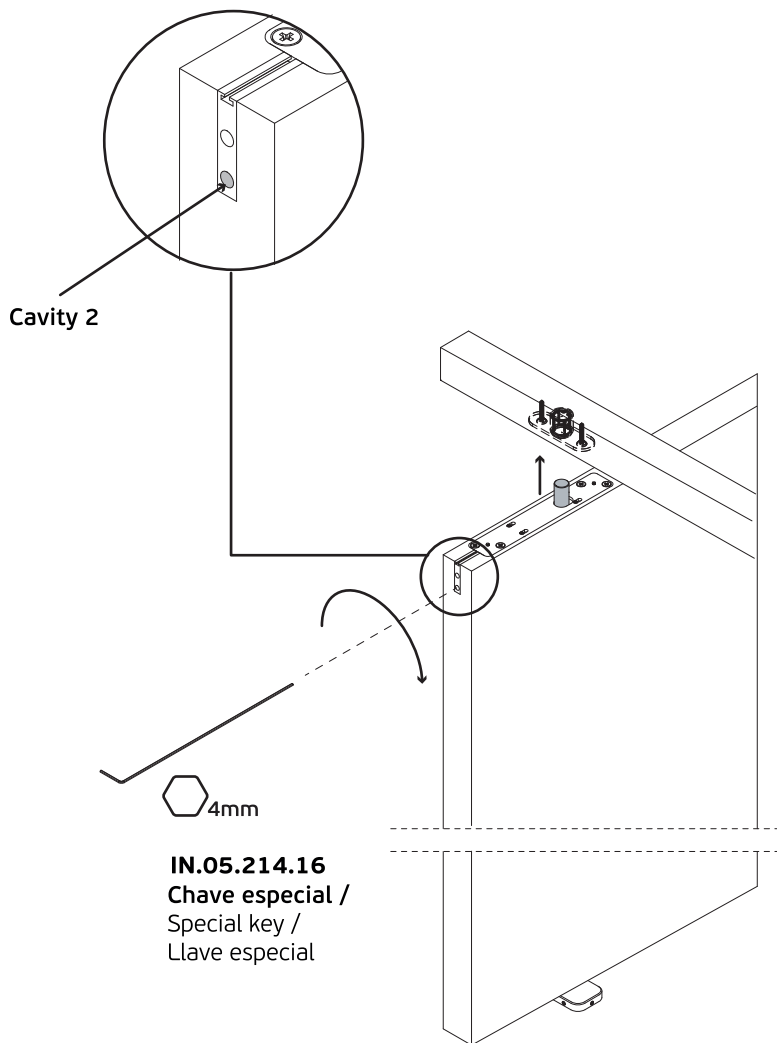

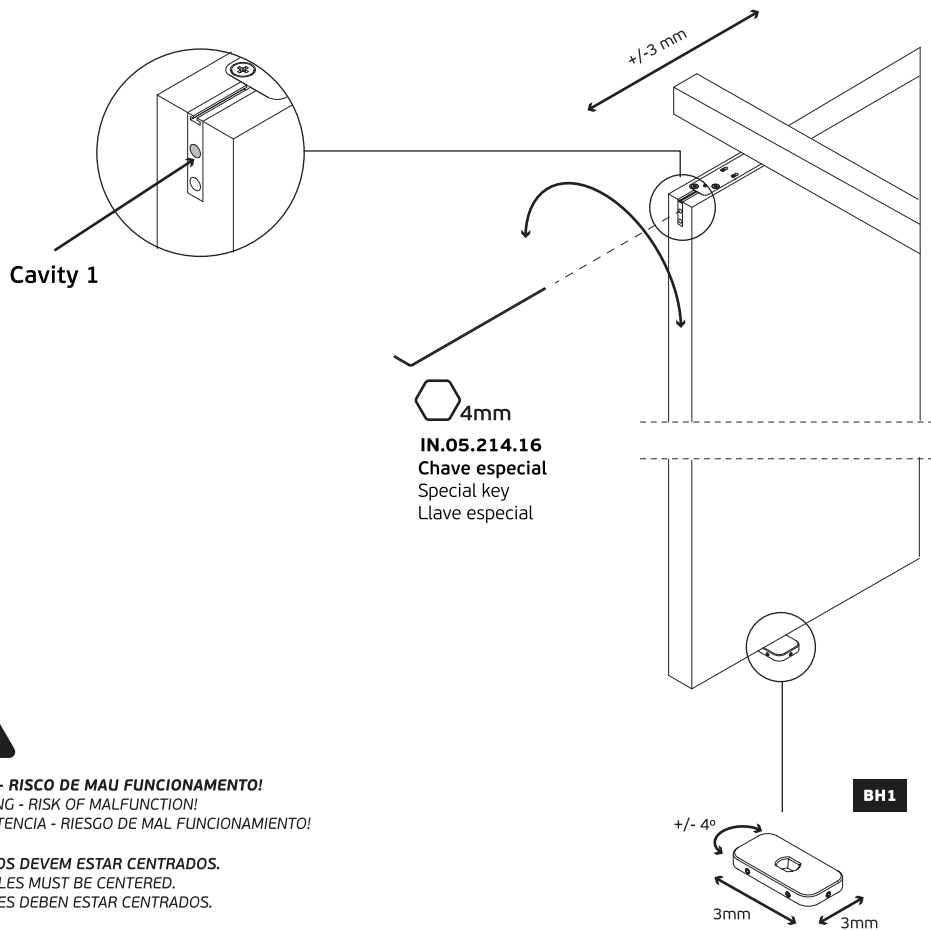

AVISO - RISCO DE MAU FUNCIONAMENTO!
WARNING - RISK OF MALFUNCTION!
ADVERTENCIA - RIESGO DE MAL FUNCIONAMIENTO!

OS EIXOS DEVEM ESTAR CENTRADOS.
THE AXLES MUST BE CENTERED.
LOS EJES DEBEN ESTAR CENTRADOS.

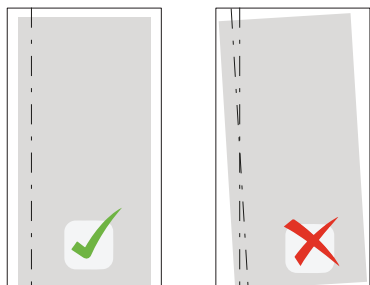

Ajuste de posição / Position adjustment / Ajuste de posición

BH1 STANDARD

BH2 OPTIONAL

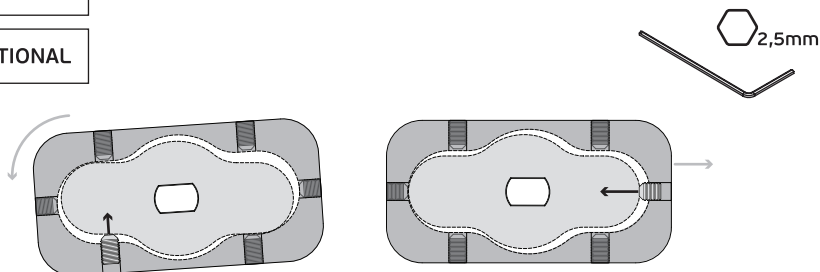

No ajuste da posição da porta, o sentido do movimento é oposto ao sentido do parafuso.
When adjusting the door position, the direction of movement is opposite to the direction of the screw.
Al ajustar la posición de la puerta, la dirección del movimiento es opuesta a la dirección del tornillo.

BH3 OPTIONAL

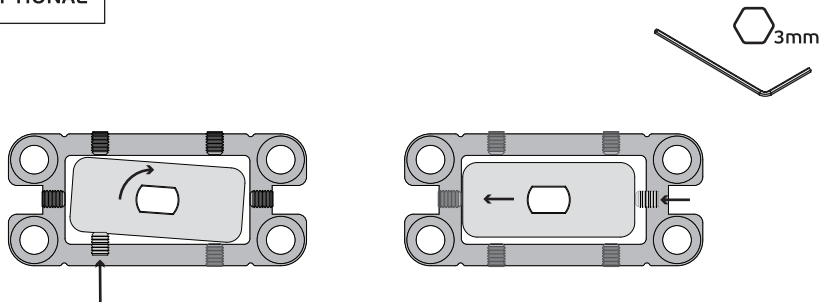

No ajuste da posição da porta, o sentido do movimento é igual ao sentido do parafuso.
When adjusting the door position, the direction of movement is the same as the direction of the screw.
Al ajustar la posición de la puerta, la dirección del movimiento es la misma que la del tornillo.

BH4 OPTIONAL

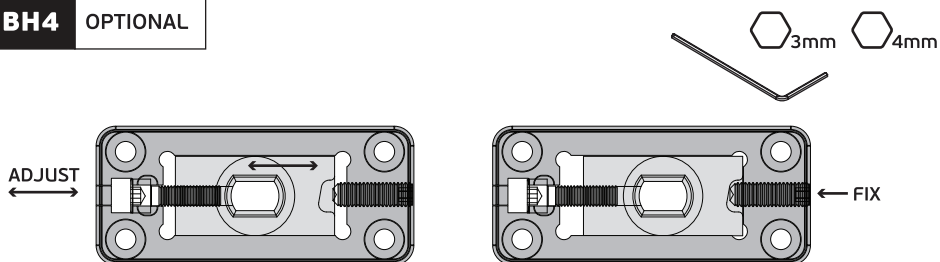

No ajuste da posição da porta, o sentido do movimento é igual ao sentido do parafuso.
When adjusting the door position, the direction of movement is the same as the direction of the screw.
Al ajustar la posición de la puerta, la dirección del movimiento es la misma que la del tornillo.

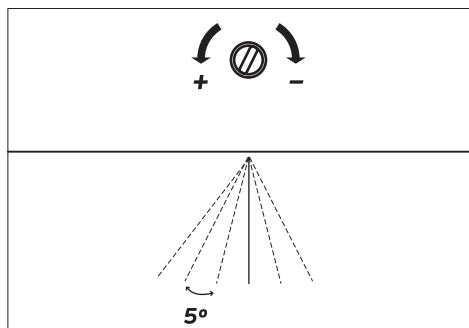
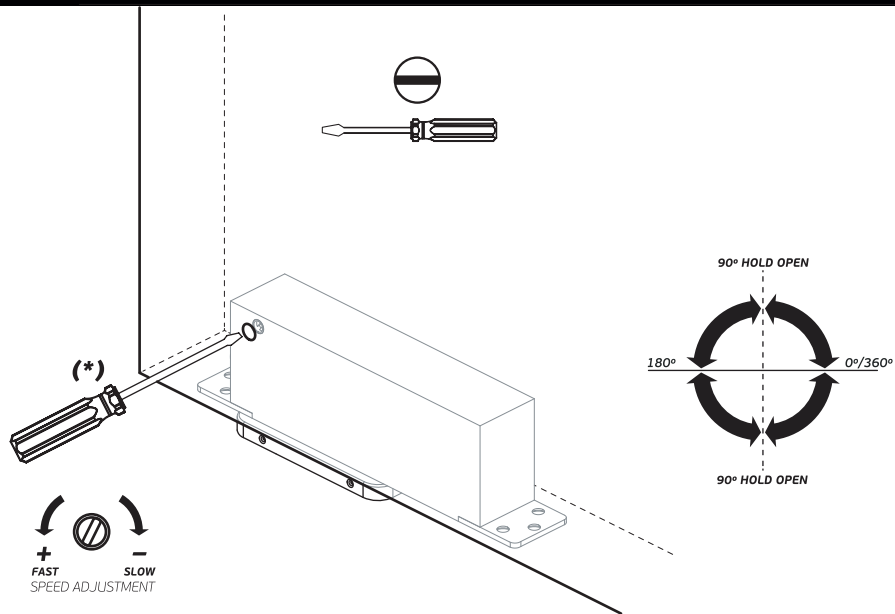

AVISO - RISCO DE DANOS!
WARNING - RISK OF DAMAGE!
ADVERTENCIA - RIESGO DE DAÑOS!

Não force ao apertar ou desapertar. Não exceda o ângulo de 5° sem testar.
Faça movimentos suaves ao apertar ou desapertar.
Não force o pivot se a porta não fechar.

Do not force when tightening or loosening. Do not exceed the 5° angle without testing.
Make smooth movements when tightening or loosening.
Do not force the pivot if the door doesn't close.

No fuerce al apretar o aflojar. No exceda el ángulo de 5° sin probar.
Realice movimientos suaves al apretar o aflojar.
No fuerce el pivote si la puerta no cierra.

IN.17.012

Retentor magnético. Material: Neodímio (Preto) /
Magnetic retainer. Material: Neodymium (Black) /
Retenedor magnético. Material: Neodímio (Negro)

Acessório opcional para auxiliar a retenção
nos 0° em caso de variações de pressão elevadas.

Optional accessory to assist retention at 0°

in case of high pressure variations.

Accesorio opcional para ayudar a la retención

a 0° en caso de variaciones elevadas de presión.

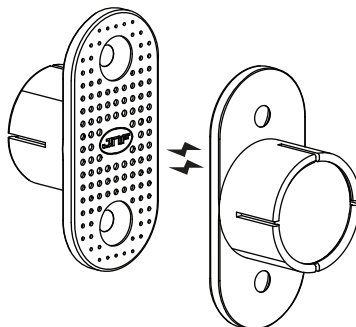

J. Neves & Filhos
Comércio e Indústria de Ferragens, S.A.

Rua das Mimosas, 851
Zona Industrial das Mimosas
4510-329 Gondomar, PORTUGAL

jnf@jnf.pt | WWW.JNFHARDWARE.COM

